

RENTAL

2023 Catalog



WE ARE YOUR TRUSTED SOLUTION SUPPLIER

When you don't feel purchasing is an option, rent the equipment you need to get the job done. Get rentals by the day, week, month or season. We also offer "Rent-to-Own" plans...or you can purchase our rental equipment at reduced rates.

10.23



RENTAL POLICIES



sales@mqb.com
www.MQB.com

Rental Rates

Rates are listed by Day, Week, and 4 Weeks.
Important: We charge for time out, not time used. All rental rates are FOB our dock.

Rental Deposit

A deposit of \$500 , payable by cash or credit card, is required at the time of rental.

Delivery and Pick-up Rates

Deliveries and pick-up are subject to the following rates:
0-25 miles.....\$50 one-way
Over 25 miles.....\$50 per hour from time of departure to time of return
Scaffold delivery.....\$50 per hour from time of departure to time of return

Trailer Rental w/ Equipment

\$25Daily Rate
\$75Weekly Rate
\$225Monthly Rate

Overtime Rate Schedule

For all rentals exceeding the normal 8-hour day / 40-hour week rental period, the following overtime rates will be applied:

8 Hours.....Daily Rate
40 Hours.....Weekly Rate
41 - 80 Hours.....1½ Times Weekly Rate
81 - 120 Hours.....2 Times Weekly Rate
121 - 175 Hours.....4-Week Rate
176 - 352 Hours.....1½ Times 4-Week Rate
176 - 352 Hours.....2 Times 4-Week Rate

Terms and Conditions

Additional rental policies can be found on the inside back page.

*Unfortunately, changes in manufacturing costs may occasionally cause our published prices to change without notice. These prices are limited to stock on hand. We reserve the right to correct typographical or pricing errors.

04/01/23

Table of Contents

Air Compressors	2
Air Hammers, Drills, & Chippers.....	2
Air Nailers & Staplers	2
Air Tool Accessories	2
Aluminum Staging Plank / Accessories	9
Baker Scaffold & Accessories	9
Blowers & Fans	7
Concrete Buckets, Screeds & Floats.....	5
Concrete Vibrators	4
Confined Space Safety Equipment	7
Core Drills	3
Cut Break Saws	3
Demolition Equipment.....	4
Diamond Blades & Core Bits	3
Drain Snakes	7
Drywall Sander & Vacuum.....	2
Excavators, Mini.....	8
Firestop Sprayers	7
Floor Preparation Equipment.....	5
Gas Engine Scrubbers	6
Gas Generators	6
Hammer Drills & Rotary Hammers	6
Hand-Held Cut-Off Saws	3
Heaters	6
Hydraulic Equipment	4
Jahn Concrete Forming System.....	5
Lasers	4
Lifting / Moving Equipment.....	8
Light Towers	8
Masonry Table Saws & Tile Saws	3
Metal Bending Brake	6
Mini Excavators.....	8
Mixers	5
Outdoor Power Equipment	8
Plate Tampers, Rollers, Uprights & Reversibles	4
Post Hole Digger	8
Power Buggy	4
Power Trowels	5
Pressure Washers	7
Pumps & Accessories	7
Scaffolding	9
Telescoping Boom & Scissor Lifts	9
Utility Loader and Trencher.....	8
Walk-Behind Saws	3
Wood Chippers.....	8



AIR COMPRESSORS



Item #	Description	Day Rate	Week Rate	4 Week Rate
IRAC#	Diesel Compressor (185CFM)	\$100	\$300	\$750
GAC#	Gas Compressor (5HP)	\$35	\$105	\$315
EAC1#	Portable Air Compressor	\$30	\$90	\$200

AIR TOOL ACCESSORIES

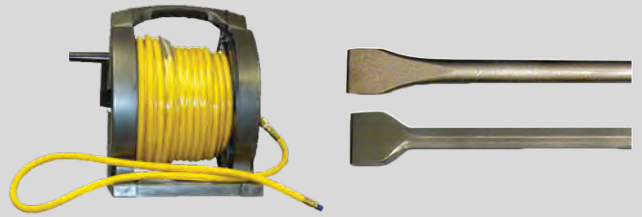

Item #	Description	Day Rate	Week Rate	4 Week Rate
AH38	3/8" X 50' Air Hose	\$4	\$8	\$20
AH12	1/2" X 50' Air Hose	\$4	\$8	\$20
AH34	3/4" X 50' Air Hose	\$5	\$15	\$40
AS-RA	Asphalt Cutter	\$8	\$16	-
(SIZE)DR	Drill Rod	\$10	\$20	-
MP	Point	\$5	\$15	-
1C	1" Chisel	\$5	\$15	-
3C	3" Chisel	\$6	\$18	
SCC	Supercut	\$6	\$18	
HITCH#	Pintle Hitch	\$5	\$15	\$45

AIR NAILERS & STAPLERS



Item #	Description	Day Rate	Week Rate	4 Week Rate
AN#	Air Nailer	\$30	\$90	\$200
AS#	Air Stapler	\$30	\$90	\$200
AS#	Hardwood Floor Stapler	\$35	\$105	\$300

Why Not Rent To Own?

Ask your sales representative how today.

AIR HAMMERS, DRILLS & CHIPPERS



Item #	Description	Day Rate	Week Rate	4 Week Rate
AC#	20 - 30LB Chipper	\$30	\$90	\$180
PB40#	40LB Hammer	\$35	\$105	\$300
PB60#	60LB Hammer	\$35	\$105	\$300
PB80#	80LB Hammer	\$40	\$120	\$350
AD#	Air Drill (32A)	\$50	\$150	\$325
LHC#	LH Air Chisel	\$33	\$99	\$270

DRYWALL SANDER & VACUUM



Item #	Description	Day Rate	Week Rate	4 Week Rate
DWS#	Drywall Sander*	\$35	\$100	\$250
DWV#	Drywall Vacuum*	\$25	\$75	\$225

*Required vacuum bags and sanding discs sold separately



WALK BEHIND SAWS



Item #	Description	Day Rate	Week Rate	4 Week Rate
FS18#	18" Capacity, Push Saw	\$75	\$225	\$600
FS20#	14"-20" Capacity; Self-Propelled	\$100	\$300	\$800
FS26#	20"-26" Capacity; Self-Propelled	\$175	\$525	\$1,500
FS65#	30"-36" Capacity; Self-Propelled	\$200	\$600	\$1,800
EFS#	5HP Electric Floor Saw	\$75	\$225	\$675
SCS#	Soff Cut Saw	\$125	\$350	\$600

CORE DRILLS



Item #	Description	Day Rate	Week Rate	4 Week Rate
HCD#	Hand Core Drill	\$75	\$225	\$675
CD#	Core Drill Rig	\$75	\$225	\$675
CDV#	Vacuum Base (for Core Drill Rig)	\$15	\$50	\$175
WT	Water Tank	\$5	\$10	\$30
CBE	Core Extension Bits	\$5	\$10	\$30

MASONRY TABLE SAWS & TILE SAWS



Item #	Description	Day Rate	Week Rate	4 Week Rate
MTS#	14" Masonry Table Saw - Gas	\$60	\$180	\$540
MTS20#	20" Masonry Table Saw - Gas	\$80	\$240	\$600
TS#	Tile Saw (with blade)	\$60	\$180	\$500

CUT-N-BREAK SAWS



Item #	Description	Day Rate	Week Rate	4 Week Rate
CNBG#	Gas Cut & Break Saw	\$125	\$350	\$650
CNBE#	Electric Cut & Break Saw	\$125	\$350	\$650
DB9#	9" Diamond Blade	\$2.50/1000 TH		

DIAMOND BLADES & CORE BITS



Item #	Description	Day Rate	Week Rate	4 Week Rate
DB14#	14" Diamond Blade	\$2.50/1000 TH		
DB20#	20" & 26" Diamond Blade	\$3.50/1000 TH		
DB30#	30" & 36" Diamond Blade	\$6.00/1000 TH		
CHAIN/ BAR	Diamond Chain	\$25.00/1000 TH		
RBBC	Rock Boss Bar & Chain	\$6.00/1000 TH		
DCB(- SIZE)#	Diamond Core Bits	Diameter x Depth x \$0.75		

HAND-HELD CUT-OFF SAWS



Item #	Description	Day Rate	Week Rate	4 Week Rate
ECS#	Electric Cut-Off Saw	\$50	\$150	\$315
GCS#	Gas Cut-Off Saw	\$50	\$150	\$350



Utica, NY: 315•724•7119
 Watertown, NY: 315•788•2612
 Syracuse, NY: 315•671•4400

HYDRAULIC EQUIPMENT



Item #	Description	Day Rate	Week Rate	4 Week Rate
HCS14#	14" Circular Saw	\$65	\$195	\$540
HCS20#	20" Circular Saw	\$65	\$195	\$540
H.CHAIN SAW#	Chain Saw with 15" Bar	\$90	\$270	\$800
HPU#	Hydraulic Power Unit	\$90	\$270	\$800
HH2	Hydraulic Hose	\$20	\$60	\$80
HH3	Hydraulic Hose	\$20	\$60	\$80

POWER BUGGY



Item #	Description	Day Rate	Week Rate	4 Week Rate
PB2#	Ride On	\$150	\$400	\$1,200

CONCRETE VIBRATORS



Item #	Description	Day Rate	Week Rate	4 Week Rate
PV14#	Vibrator - Flex Shaft (7'-14')	\$40	\$120	\$330
PV21#	Vibrator - Flex Shaft (21')	\$40	\$120	\$330
BPV#	Back Pack Vibrator	\$65	\$195	\$540
HV#	Handy Vibe (Isko)	\$45	\$135	\$375
EXTSD	Extension Cords	\$5 each/day		

LASERS



Item #	Description	Day Rate	Week Rate	4 Week Rate
LL#	Laser Level, Rod-Eye & Bracket	\$50	\$150	\$400
MGL#	Multi-Grade Laser Level, Rod-Eye	\$80	\$250	\$750
IL#	Interior Red Light Laser	\$75	\$225	\$630
TRI-POD#	Tripod	\$5	\$15	\$45

DEMOLITION EQUIPMENT



Item #	Description	Day Rate	Week Rate	4 Week Rate
EC#	20LB Electric Chipper	\$40	\$120	\$300
EPB#	60LB Electric Breaker	\$70	\$210	\$600
CPB#	Milwaukee Cordless Breaker	\$70	\$210	\$600

PLATE TAMPERS, ROLLERS, UPRIGHTS & REVERSIBLES

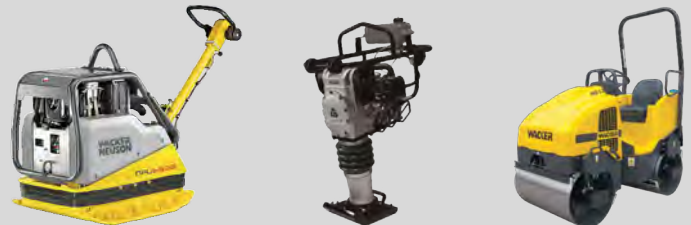

Item #	Description	Day Rate	Week Rate	4 Week Rate
UT#	Upright Tamper	\$80	\$240	\$480
PT1#	Vibratory Plate	\$80	\$240	\$600
RPT1#	20" Reversible Vibratory Plate	\$100	\$300	\$900
RPT2#	24" Reversible Vibratory Plate	\$150	\$440	\$1,200
RPT4#	28" Reversible Vibratory Plate	\$200	\$600	\$1,800
ROR#	Ride On Roller	\$125	\$375	\$1,125



MIXERS



Item #	Description	Day Rate	Week Rate	4 Week Rate
MM8#	Mortar Mixer 9CF - Gas	\$100	\$300	\$600
CM#	Concrete Mixer 6CF - Gas	\$100	\$300	\$600
PCM#	Portable Concrete Mixer 3CF - Electric	\$40	\$100	\$300

POWER TROWELS



Item #	Description	Day Rate	Week Rate	4 Week Rate
T36#	36" Trowel (blades additional)	\$75	\$200	\$600
T46#	46" Trowel (blades additional)	\$75	\$200	\$600
FB	Trowel Finish Blades (set of 4)	\$20	\$40	-
FLB	Trowel Float Blades (set of 4)	\$20	\$40	-
CBRA	Combo Blades (set of 4)	\$20	\$40	-

CONCRETE BUCKETS, SCREEDS & FLOATS



Item #	Description	Day Rate	Week Rate	4 Week Rate
BF#	Bull Float w/ 3 Handles	\$25	\$50	\$150
CS2#	Magic Screed (Gas) Motor Unit	\$75	\$225	\$600
SB(size)#	Screed Board: 6'-16' (2' increments)	\$25	\$75	\$150
CB#	1yd Concrete Bucket (Watertown Only)	\$75	\$225	\$600

CORDLESS REBAR TIER



Item #	Description	Day Rate	Week Rate	4 Week Rate
CRT#	Cordless Rebar Tier	\$100	\$225	\$600

FLOOR PREPARATION EQUIPMENT



Item #	Description	Day Rate	Week Rate	4 Week Rate
VR#	100LB Vinyl Roller	\$30	\$75	\$225
EFB#	Electric Floor Buffer	\$40	\$120	\$360
EFG#	Double Head Floor Grinder	\$100	\$300	\$540
EFG2#	Single Head Floor Grinder	\$100	\$300	\$900
EFG3#	220v Single Head Floor Grinder	\$150	\$450	\$1,350
DGS	Diamond Grinding Stones	\$100	-	-
EFV#	Electric Floor Vacuum	\$60	\$120	\$360
AFS#	Concrete Floor Scabblers - Air	\$200	-	-
GS#	Concrete Scarifier - Gas	\$200	-	-
BUR#	Concrete Burnisher	\$200	\$600	\$1,800
HFS#	Hardwood Floor Sander	\$50	\$200	\$600
HFE#	Hardwood Floor Edger	\$40	\$150	\$450
HOS#	Hardwood Orbital Sander	\$65	\$195	\$585
FS2#	Floor Stripper	\$40	\$90	\$270
ERFS	Electric Ride-On Floor Scrubber	\$150	\$450	\$1,250

JAHN CONCRETE FORMING SYSTEM

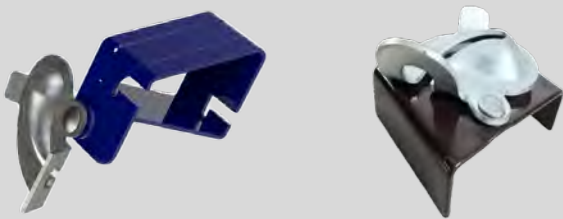

Item #	Description	Day Rate	Week Rate	4 Week Rate
JAC	Jahn "A" Bracket	-	\$0.20	\$0.50
JCC	Jahn "C" Bracket	-	\$0.20	\$0.50
TE	Jahn Tie Extenders	-	\$0.10	\$0.20
JB	Jahn Scaffolding Brackets	-	\$2.00	\$5.00
JCB	Jahn Corner Bracket	-	\$1.25	\$3.00
HP	Hair Pin Wedge	-	\$0.10	\$0.20
TB-RA	Turnbuckle Form Aligner	-	\$0.75	\$2.00



Utica, NY: 315•724•7119
 Watertown, NY: 315•788•2612
 Syracuse, NY: 315•671•4400

HAMMER DRILLS & ROTARY HAMMERS



Item #	Description	Day Rate	Week Rate	4 Week Rate
ERH1#	SDS Rotary Hammer	\$25	\$75	\$150
ERH2#	Spline or SDS Max Rotary Hammer	\$40	\$120	\$360
MD#	Magnetic Base Drill	\$50	\$150	\$350
SPLINE(-SIZE)	Spline Rotary Hammer Bits	\$10	\$20	-
SDS(-SIZE)	SDS Rotary Hammer Bits	\$10	\$20	-

HEATERS



Item #	Description	Day Rate	Week Rate	4 Week Rate
EH1#	5,100BTU; 110V Electric	\$20	\$60	\$180
EH2#	30,700BTU; 240V Electric	\$40	\$120	\$360
KH1#	110,000BTU Kerosene	\$27	\$81	\$225
KH2#	165,000BTU Kerosene	\$33	\$99	\$270
KH3#	350,000BTU Kerosene	\$50	\$150	\$400
PH1#	150,000BTU Propane/LP	\$33	\$99	\$250
PH2#	375,000BTU Propane/LP	\$45	\$135	\$360
PH3#	400,000BTU Propane/LP	\$55	\$165	\$500

METAL BENDING BRAKE

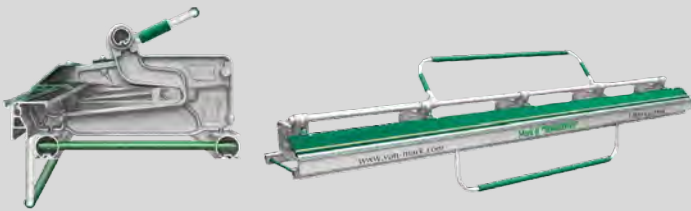

Item #	Description	Day Rate	Week Rate	4 Week Rate
B1#	8.5' Brake (26GA Galv. Steel, 21GA aluminum)	\$75	\$200	\$600
B2#	10.5' Brake (26GA Galv. Steel, 21GA aluminum)	\$85	\$250	\$750

DID YOU KNOW WE HAVE A SERVICE DEPARTMENT?

We can repair your tools with a satisfaction guarantee. We are a Stihl Service Wrench certified location.

GAS ENGINE SCRUBBERS

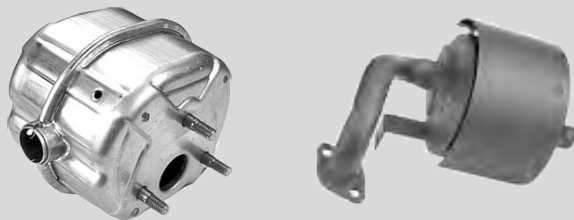

Item #	Description	Day Rate	Week Rate	4 Week Rate
GS5#	Gas Scrubber for 5HP	\$30	\$90	\$270
GS13#	Gas Scrubber for 13HP	\$30	\$90	\$270
GS20#	Gas Scrubber for 20HP	\$30	\$90	\$270

GAS GENERATORS



Item #	Description	Day Rate	Week Rate	4 Week Rate
EUG2#	2,000WATT Quiet Generator	\$50	\$150	\$400
EUG3#	3,000WATT Quiet Generator	\$70	\$200	\$600
G5#	5,000WATT	\$70	\$200	\$600
G6#	5,500WATT - 6,500WATT	\$80	\$240	\$700
G10#	10,000WATT	\$100	\$300	\$900



PRESSURE WASHERS



Item #	Description	Day Rate	Week Rate	4 Week Rate
CPW#	Cold Water Pressure Washer - Gas	\$60	\$180	\$450
HPW#	Hot Water Pressure Washer - Gas or Electric	\$90	\$270	\$650
TW#	Telescoping Wand	\$10	\$30	\$90
PWTN	Spray Turbo Nozzle	\$10	\$30	-
PWH	50' Pressure Washer Hose	\$8	\$20	\$50

PUMPS & ACCESSORIES



Item #	Description	Day Rate	Week Rate	4 Week Rate
EP2A#	2" Submersible 115v Electric Pump	\$30	\$90	\$200
TP2#	2" Trash Pump - Gas	\$40	\$120	\$350
TP3#	3" Trash Pump - Gas	\$50	\$150	\$450
DP3#	3" Diaphragm Pump - Gas	\$50	\$150	\$450
TP4#	4" Trash Pump - Gas	\$75	\$225	\$675
2DH	2" x 50' Discharge Hose	\$5	\$15	\$40
3DH	3" x 50' Discharge Hose	\$8	\$20	\$60
4DH	4" x 50' Discharge Hose	\$10	\$25	\$75
2SH	2" x 20' Suction Hose	\$8	\$20	\$50
3SH	3" x 20' Suction Hose	\$10	\$30	\$60
4SH	4" x 20' Suction Hose	\$20	\$35	\$90

FIRESTOP SPRAYERS



Item #	Description	Day Rate	Week Rate	4 Week Rate
FSS#	Mark IV	\$100	\$300	\$900

DRAIN SNAKES



Item #	Description	Day Rate	Week Rate	4 Week Rate
DS1#	PowerVee 1 1/4"-3" Snake	\$25	\$75	\$225
DS2#	Mini Rooter 2"-4" (No Roots)	\$40	\$120	\$360
DS3#	Easy Rooter 4"-10"	\$60	\$180	\$500

We are open
Mon - Fri: 7:00am - 5:00pm

CONFINED SPACE SAFETY EQUIPMENT



Item #	Description	Day Rate	Week Rate	4 Week Rate
CSRS#	Rescue/Retrieval Tripod	\$80	\$300	\$750
CSGM#	Gas Detector	\$110	\$330	\$900
CALI	Gas Detector Calibration	\$20 each calibration		
BUMP	Gas Detector Bump Test	\$20 each test		

BLOWERS & FANS

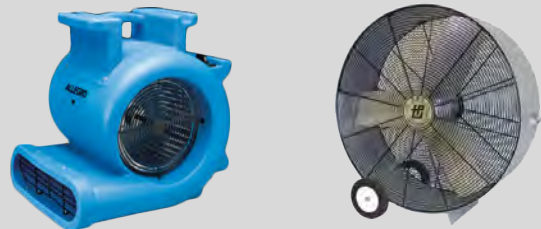

Item #	Description	Day Rate	Week Rate	4 Week Rate
EF#	Exhaust Fan (36")	\$25	\$66	\$180
VB#	Ventilation Blower with Hose	\$25	\$75	\$225
FD#	Floor Dryer	\$30	\$90	-
NAM	HEPA Air Scrubber/Negative Air Machine	\$40	\$120	\$360



Utica, NY: 315•724•7119
 Watertown, NY: 315•788•2612
 Syracuse, NY: 315•671•4400

8

OUTDOOR POWER EQUIPMENT



Item #	Description	Day Rate	Week Rate	4 Week Rate
BPB#	Backpack Blower	\$40	\$100	\$300
HHB#	Handheld Blower	\$20	\$60	\$120
WC#	7" Wood Chipper	\$200	\$600	\$1,800
PS#	Stihl Power Broom (Sweeper)	\$60	\$180	\$480
WBB#	Walk Behind Blower	\$60	\$180	\$540

POST HOLE DIGGER AND POST DRIVER



Item #	Description	Day Rate	Week Rate	4 Week Rate
PHD2#	Post Hole Digger (8", 10", or 12" bit)	\$110	\$330	\$990
PHD#	Stihl One-Man Auger	\$50	\$150	\$400
SA4	3.5" Stihl Auger Bit	\$10	\$30	\$90
SA6	5.9" Stihl Auger Bit	\$10	\$30	\$90
SA8	7.9" Stihl Auger Bit	\$10	\$30	\$90
GPD#	Gas Post Driver	\$90	\$270	\$810

MINI EXCAVATORS



Item #	Description	Day Rate	Week Rate	4 Week Rate
ME1#	1 Ton Mini Excavator	\$350	\$1,000	\$3,000
ME2#	3 Ton Mini Excavator	\$400	\$1,200	\$3,500

LIGHT TOWERS

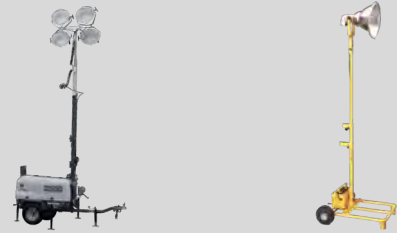

Item #	Description	Day Rate	Week Rate	4 Week Rate
IRLP#	Portable Light Plant / 8KW	\$110	\$300	\$500
LP#	Single Light Tower (needs AC/generator)	\$30	\$90	\$225

TELESCOPING BOOM & SCISSOR LIFTS



Item #	Description	Day Rate	Week Rate	4 Week Rate
BL#	Telescopic Boom Lift - 37.5'	\$250	\$750	\$2,250
AL#	Articulating Boom Lift - 45'	\$300	\$900	\$2,700
AL55#	Articulating Boom Lift - 55'	\$350	\$1,050	\$3,150
SL#	19' Scissor Lift	\$150	\$400	\$700
SL2#	26' Scissor Lift	\$200	\$600	\$1,000

UTILITY LOADER AND TRENCHER



Item #	Description	Day Rate	Week Rate	4 Week Rate
DING#	Dingo TX427 Narrow Track w/ Bucket	\$250	\$750	\$2,250
DING2#	Dingo TX1000 Wide Track w/ Bucket	\$350	\$1,000	\$3,000
TREN#	6" x 36" Trencher	\$50	\$150	\$450
DA9	9" Auger	\$50	\$150	\$450
DA12	12" Auger	\$50	\$150	\$450
DA15	15" Auger	\$50	\$150	\$450
DA18	18" Auger	\$50	\$150	\$450
DA24	24" Auger	\$50	\$150	\$450
DEXT	24" Extension	\$10	\$30	\$90



LIFTING / MOVING EQUIPMENT



Item #	Description	Day Rate	Week Rate	4 Week Rate
DL#	10' Drywall Lift	\$40	\$100	\$300
DL14#	14' Drywall Lift	\$50	\$150	\$450
DWC#	Drywall Cart	\$25	\$75	\$225
ML18#	18' Material Lift - 650#	\$75	\$225	\$675
LH#	Ladder/Platform Hoist - Gas, 28'	\$100	\$300	\$900
PALT	27" x 48" 6600 lb Pallet Truck	\$25	\$75	\$225

Know Your Scaffold / Safety / Decals

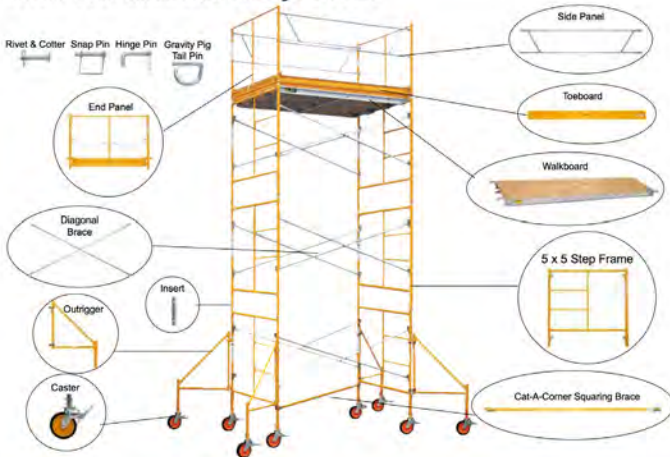

ALUMINUM STAGING PLANK / ACCESSORIES

Item #	Description	Day Rate	Week Rate	4 Week Rate
AP12#	12" Wide Aluminum Picks	\$20	\$60	\$150
AP20#	20" Wide Aluminum Picks	\$25	\$75	\$175

BAKER SCAFFOLD & ACCESSORIES

Item #	Description	0-14 Day Rate	15-28 Day Rate
BLF	Baker Ladder Frame	\$5	\$8
BB	Baker Brace	\$5	\$8
BDB	Baker Deck Board	\$8	\$12
AOU3	39" Add-On Unit	\$30	\$45
AOU5	60" Add-On Unit	\$30	\$45
WB4	Wide Base Unit - Set	\$15	\$30
BOUTW	Outrigger	\$3	\$6
PG6	6' Panel Guard - Set	\$15	\$25
BC	Casters	\$3	\$6

SCAFFOLDING

Item #	Description	0-14 Day Rate	15-28 Day Rate
WTF	Walk Thru Frame	\$6	\$9
WTSF	Walk Thru Step Frame	\$6	\$9
SF2X5	Step Frame - 2' x 5'	\$6	\$9
SF3X5	Step Frame - 3' x 5'	\$6	\$9
SF46X5	Step Frame - 4'6" x 5'	\$6	\$9
SF66X5	Step Frame - 6'6" x 5'	\$6	\$9
SF6X28	Step Frame - 6' x 28"	\$6	\$9
SF3X28	Step Frame - 3' x 28"	\$6	\$9
B127	Brace - 2'/3'	\$3	\$5
B347	Brace - Double Hole	\$3	\$5
SA20	Side Arm Bracket	\$4	\$7
SAADJ	Adjustable Side Arm Bracket	\$4	\$7
CAS8	Casters	\$6	\$12
SJ	Screw Jack	\$4	\$7
SJB	Screw Jack Bare	\$4	\$7
BP	Base Plate	\$2	\$3
PL2X8	8' Laminated Wood Plank	\$6	\$10
PL2X16	16' Laminated Wood Plank	\$6	\$10
AP7	7' x 19" Aluminum Frame Platform	\$10	\$18
AP287	7' x 28" Aluminum Frame Platform	\$16	\$30
APD287	7' x 28" Aluminum Frame Platform w/Door	\$16	\$30
AP10	10' x 19" Aluminum Frame Platform	\$25	\$45
EGPA5	End Guard Rail Assembly	\$5	\$10
GP	Guard Post	\$2	\$4
GR5	5' Guard Rail	\$2	\$4
GR7	7' Guard Rail	\$2	\$4
TB2X5	2' x 5' Toe Board	\$2	\$4
TB2X7	2' x 7' Toe Board	\$2	\$4
STAB	Stabilizer	\$5	\$10
SAGR	Side Arm Guard Rail Assembly	\$3	\$6
PR	Platform Rest	\$2	\$4
ACCST	Access Stairway Pair	\$10	\$20
STRAIL	Stair Rail	\$10	\$20
CT	Canopy Top	\$4	\$6
CCB	Cat-A-Corner Brace	\$2	\$4
DG	Diagonal Goosier	\$2	\$4
HA-RS	Hoist Arm	\$4	\$8
WW	Well Wheel	\$10	\$15
HP2	Hinge Pins	\$0.25	\$0.50



TERMS & CONDITIONS

1. **INSPECTION.** Customer acknowledges that he has had an opportunity to personally inspect the equipment, and finds it suitable for his needs and in good condition, and that he understands its proper use. Customer further acknowledges his duty to inspect the equipment prior to use and notify Dealer of any defects.
2. **REPLACEMENT OF MALFUNCTIONING EQUIPMENT.** If the equipment becomes unsafe or in disrepair as a result of normal use, Customer agrees to discontinue use and notify Dealer who will replace the equipment with similar equipment in good working order, if available. Dealer is not responsible for any incidental or consequential damages caused by delays or otherwise.
3. **WARRANTIES. THERE ARE NOT WARRANTIES OR MERCHANTABILITY OR FITNESS, EITHER EXPRESS OR IMPLIED.** There is no warranty that the equipment is suited for Customer's intended use, or that it is free from defects.
4. **HOLD HARMLESS AGREEMENT.** Lessee agrees to indemnify and hold lessor free and harmless from any and all liability for loss, damage, or personal injury which results from non-compliance with any portion of this paragraph, or from non-compliance with any law, regulation or other safety order.
5. **PROHIBITED USES.** Use of the equipment in the following circumstances is prohibited, and constitutes a breach of this contract.
 - a. Use for illegal purpose or in an illegal manner.
 - b. Use when the equipment is in bad repair or is unsafe.
 - c. Improper, unintended use or misuse.
 - d. Use by anyone other than the Customer or his employees, without Dealer's written permission
 - e. Use at any location other than the address furnished to the Dealer without Dealer's permission.
(Does not apply to mobile equipment.)
6. **ASSIGNMENTS, SUBLEASES AND LOANS OF EQUIPMENT.** Dealer may assign his rights under this contract without Customer's consent, but will remain bound by all obligations herein. Customer may not sublease or loan the equipment without Dealer's written permission. Any purported assignment by Customer is void.
7. **TIME OF RETURN.** Customer's right to possession terminates on the expiration of the rental period ("Due In" date & time) and retention of possession after this time constitutes a material breach of this contract. **Time is the essence of this contract.** Any extension must be mutually agreed upon in writing.
8. **LATE RETURN.** Customer agrees to return the rented goods during Dealer's regular store hours, upon expiration of the rental period ("Due In" date & time). Customer agrees that if the rented goods are held beyond the expiration of the rental period ("Due In" date & time) as designated in the contract, the daily rate as indicated on the contract shall be the agreed contractual rate for the entire period, notwithstanding any lesser periodic rate.
9. **DAMAGED, DIRTY, OR LOST EQUIPMENT.** Customer agrees to pay for any damage to or loss of the goods, as an insurer, regardless of cause, except reasonable wear and tear, while the goods are out of the possession of the Dealer. Customer also agrees to pay a reasonable cleaning charge for equipment returned dirty. Accrued rental charges cannot be applied against the purchase or cost of repair or damage, lost or stolen goods. Equipment lost, stolen or damaged beyond repair will be paid for at its current list price. The cost of repairs will be borne by Customer, whether performed by the Dealer, or, at Dealer's option, by others.
10. **TIME OF PAYMENT.** Accounts are due and payable at the termination of the rental period. A carrying charge of 1.5% per month (ANNUAL RATE OF 18%) will be charged on all overdue accounts.
11. **COLLECTION COSTS.** Customer agrees to pay all reasonable collection, attorney's and court fees and other expenses involved in the collection of the changes or enforcement of Dealer's rights under this contract.
12. **REPOSSESSION.** Upon a failure to pay rent or other breach of this contract, Dealer may terminate this contract and take possession of and remove the goods from wherever they are, and Dealer and his agents shall not be liable for any claims for damage or trespass arising out of the removal of the goods.
13. **INSPECTION OF TRAILER HITCH.** Customer agrees to inspect the trailer coupling mechanism and safety chain before leaving Dealer's premises. Customer also agrees to inspect the equipment periodically (every 100 miles) and to maintain the coupling and chain in a safe and secure condition.
14. **DAMAGE TO BUMPERS.** Dealer is not liable for damage to Customer's bumper or automobile done by detachable hitches, towbars or other detachable equipment.
15. **SEVERABILITY.** The provisions of this contract shall be severable so that the invalidity, unenforceability or waiver of any of the provisions shall not affect the remaining provisions.
16. **LOADING AND UNLOADING EQUIPMENT.** Customer is responsible for loading and unloading equipment. If Dealer's employees assist in loading or unloading the equipment, Customer agrees to assume the risk of, and hold Dealer and/or its employees harmless for any property damage or personal injuries, including damage and personal injuries attributable to the negligence of Dealer and/or its employees.
17. **SAFETY REGULATIONS.** LESSEE SHALL; (1) erect, maintain and use the leased equipment in a safe and proper manner; (2) comply with all applicable laws, ordinances, rules, regulation and orders of any public authority, including, but not limited to, ALL FEDERAL OCCUPATIONAL SAFETY AND HEALTH ACT (OSHA) and State regulations having jurisdiction for the safety of persons or property; and (3) comply with any rules or regulations promulgated by lesser with respect to the leased equipment, its manner of erection and use. Lessee acknowledges receipt of Lessor's Operating Instructions and/or Code of Safe Practices, and agrees that Lessee and all Lessee's employees will AT MINIMUM comply with this provision and all other safety provisions described herein.

McQuade & Bannigan Inc.

Construction / Industrial Tools & Supplies

Got Questions?

Give us a call
or

E-mail us at
sales@MQB.com

A fourth generation family-owned business, McQuade & Bannigan has offered its customers a wide variety of industrial and construction supplies for over 100 years.

Rental, sales and service of equipment is available at all locations.



Utica

1300 Stark St.

(Corner of Rt. 12 and Noyes St.)

Utica, NY 13502

Phone: (315) 724-7119

Fax: (315) 724-0171



Watertown

22696 Murrock Cir.

Bradley St. Commerce Park

Watertown, NY 13601

Phone: (315) 788-2612

Fax: (315) 788-0361



Syracuse

6300 E. Molloy Rd.

East Syracuse, NY 13057

Phone: (315) 671-4400

Fax: (315) 671-4404