

# STRUT CLAMPS



## Clamp With Cushion

**2501-2514**

Fig. Number	O.D. Size A	Nom. Tube Size	B	C	D	Std. Package	Wt. Each (in Lbs.)
2501	$\frac{1}{4}$	$\frac{1}{8}$	$1\frac{1}{16}$	.060	$\frac{1}{2}$	30	.12
2502	$\frac{3}{8}$	$\frac{1}{4}$	$1\frac{1}{4}$	.060	$\frac{5}{8}$	30	.13
2503	$\frac{1}{2}$	$\frac{3}{8}$	$1\frac{3}{8}$	.060	$\frac{3}{4}$	30	.13
2504	$\frac{5}{8}$	$\frac{1}{2}$	$1\frac{1}{2}$	.060	$\frac{7}{8}$	20	.15
2505	$\frac{3}{4}$	$\frac{5}{8}$	$1\frac{3}{4}$	.075	$1\frac{1}{8}$	20	.21
2506	$\frac{7}{8}$	$\frac{3}{4}$	$1\frac{7}{8}$	.075	$1\frac{1}{4}$	20	.22
2507	$1\frac{1}{8}$	1	$2\frac{1}{16}$	.075	$1\frac{1}{2}$	10	.29
2508	$1\frac{3}{8}$	$1\frac{1}{4}$	$2\frac{7}{16}$	.075	$1\frac{3}{4}$	10	.33
2509	$1\frac{5}{8}$	$1\frac{1}{2}$	3	.105	$2\frac{1}{4}$	10	.42
2510	$2\frac{1}{8}$	2	$3\frac{3}{8}$	.105	$2\frac{3}{4}$	10	.50
2511	$2\frac{5}{8}$	$2\frac{1}{2}$	$3\frac{7}{8}$	.105	$3\frac{1}{4}$	10	.62
2512	$3\frac{1}{8}$	3	$4\frac{5}{16}$	.105	$3\frac{3}{4}$	10	.66
2514	$4\frac{1}{8}$	4	$5\frac{1}{2}$	.125	$4\frac{3}{4}$	10	.88

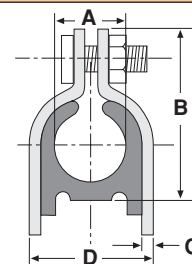

Available in stainless steel. To order, specify 304 or 316 and add suffix SS to fig. number.  
Price on request.